



FOUR SEASONS
PRIVATE RESIDENCES
PRIETA BAY AT PENINSULA PAPAGAYO
AN ECODESARROLLO PAPAGAYO AFFILIATE

PRIVATE VILLA

PRIVATE VILLA

FEATURES

- Total Living Area: 4,876 SF
- Air-Conditioned Area: 3,681 SF
- 3 Bedrooms
- 4 Bathrooms
- Media Room
- Plunge Pool
- 2-Car Garage

Terraced gently into the hillside above Prieta Bay and overlooking a wide crescent of multi-hued sands and seas, each private villa appears to grow out of the landscape, inviting the outdoors in. Thoughtfully designed windows allow interior and exterior spaces to flow freely between one another, providing an unparalleled closeness to nature. Instead of a media room, this plan may be modified to create a 4th bedroom for additional guests.

LEGEND

1. Entry
2. Foyer
3. Elevator (optional)
4. Media Room
5. Owner's Lockout Closet
6. Living Room
7. Dining Room
8. Kitchen
9. Bathroom
10. Electrical Room
11. Mechanical Room
12. BBQ Area
13. Terrace
14. Plunge Pool
15. Garage
16. Recycling



LEVEL 1



PRIVATE VILLA

LEGEND

- 17. Master Ensuite
- 18. Balcony
- 19. Outdoor Shower
- 20. Laundry
- 21. Elevator (optional)
- 22. Closet
- 23. Bedroom
- 24. Bathroom

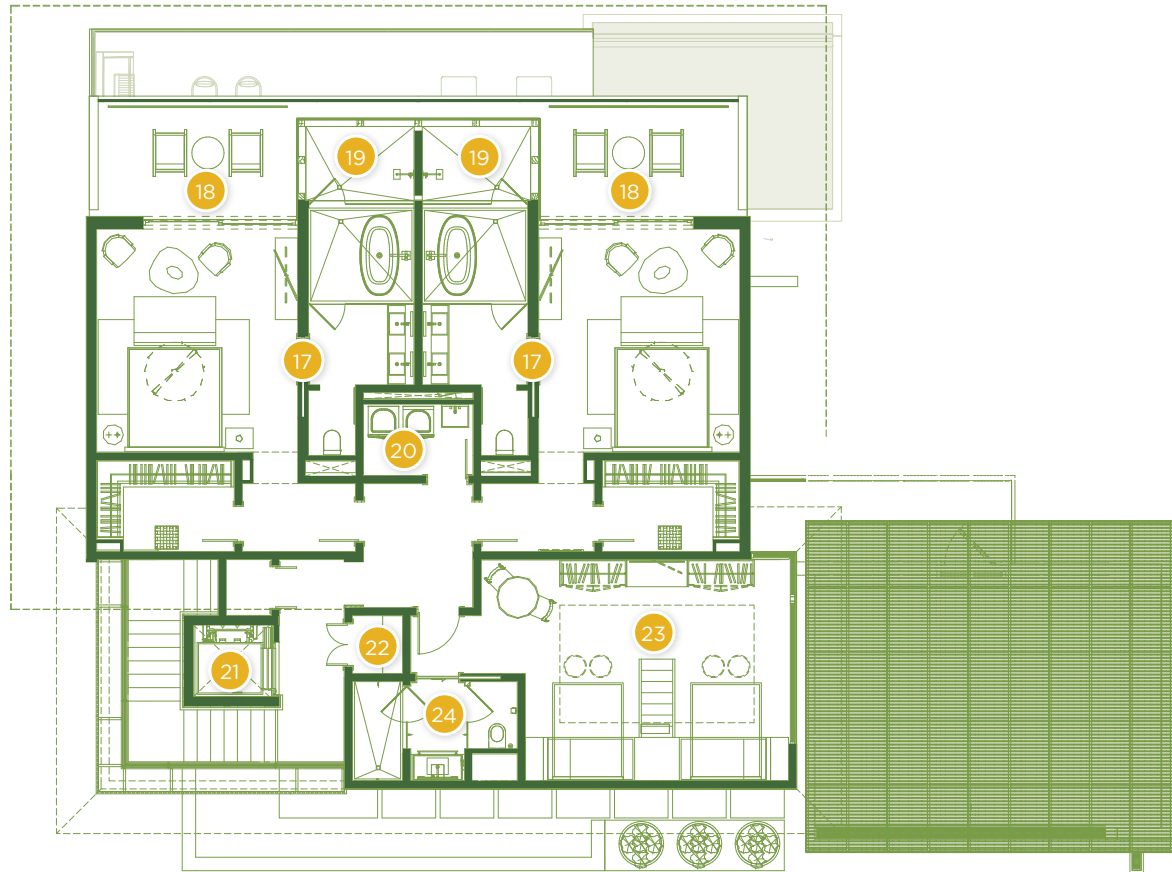

LEVEL 2

To view more photos and learn about ownership opportunities at Peninsula Papagayo, visit us online. Or call US toll-free (866) 696.2899.

www.peninsulapapagayo.com

#peninsulapapagayo



Four Seasons Private Residences Prieta Bay at Peninsula Papagayo are not owned, developed or sold by Four Seasons Hotels Limited or its affiliates (Four Seasons). The developer, Residencial PLV, Limitada, uses Four Seasons trademarks and tradenames under a license from Four Seasons Hotels and Resorts B.V. The marks "FOUR SEASONS," "FOUR SEASONS HOTELS AND RESORTS," any combination thereof and the Tree Design are registered trademarks of Four Seasons Hotels Limited in Canada and U.S.A. and of Four Seasons Hotels (Barbados) Ltd. elsewhere. Floor plans, drawings, images, renderings and other material presented herein are for illustrative purposes only, are not to scale and should not be relied upon as a basis for purchasing. Dimensions and square footage are approximate and may vary with actual construction. The developer reserves the right to make modifications or substitutions should they be necessary.

